

Tired of pinning down hems and moving the pins along as you go? Are you fed up with folding and ironing the hems first before sewing so you can get that clean professional look?

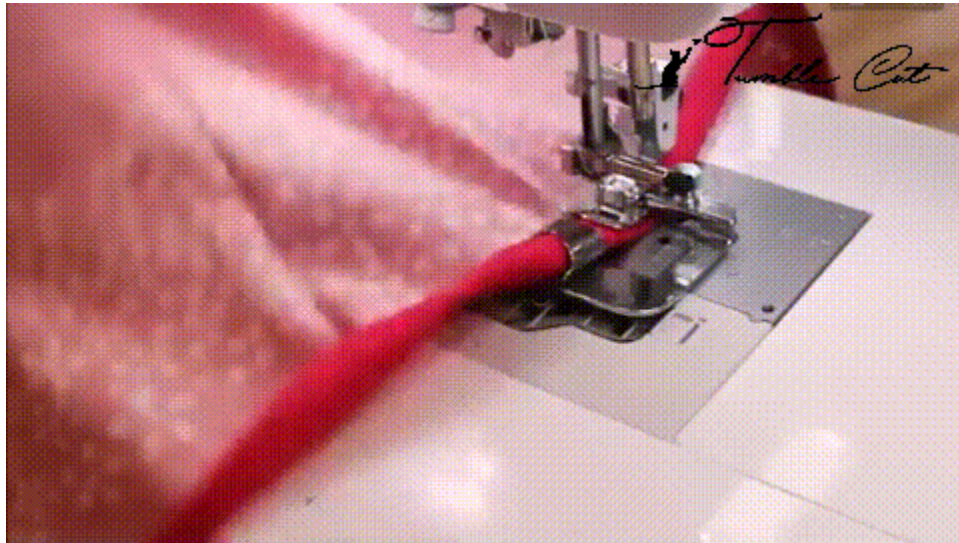

Our **Easy Hemming Sewing Foot** will *make sewing a million times easier!*

This revolutionary tool will make your sewing experience **stress-free and hassle-free.**

With its added *unique spiral design*, it firmly holds hems while you sew.

- Made of **durable hard metal material** for a long time use
- Widely used in **clothes and other projects with lightweight fabric**
- **Fits most sewing machines** such as *Brother, Singer, New Home, Janome, Toyota* and all other **domestic sewing machines with a low shank system**
- **Easy to install and easy to use**
- Adds **delicate and beautiful rolled hems** to your projects

Whether you're a novice or an expert with sewing machines, the **Easy Hemming Sewing Foot** is definitely *a must-have for any sewing kit.* Say goodbye pins and sewing chucks from now on!

HOW TO USE:

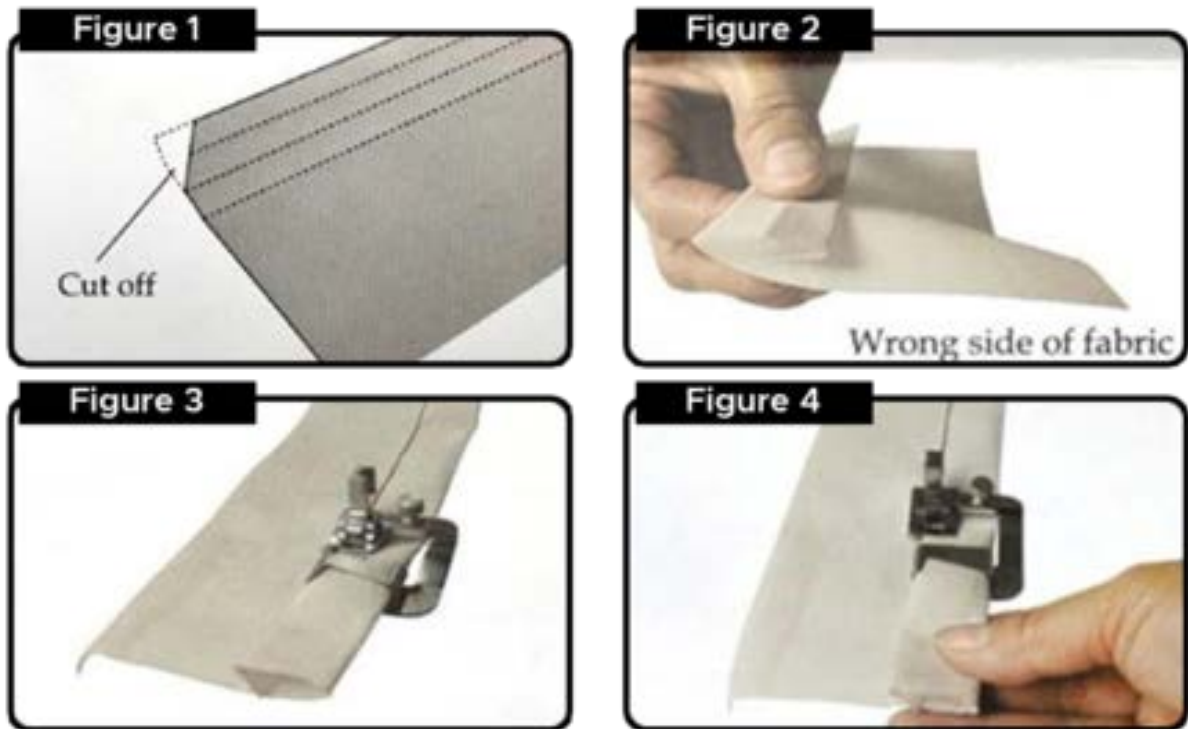

1. Select desired wide rolled hem attachment size and attach to the Sewing Foot.
2. Trim about 1.0 cm (3/8") from the corner of the cloth to make it easy to insert through the cloth entrance. **(See Figure 1)**
3. Fold fabric edge approximately 0.60 cm (1/4") and iron. **(See Figure 2)**
4. Fold fabric again and insert into the cloth entrance. **(See Figure 3)**
5. Loosen the adjustment screw and adjust position of the sliding so the machine seams hem with a 0.30 cm allowance from the first fold.
6. Lower the needle into the fabric at the point where sewing is to begin. Then lower the Sewing Foot.
7. If necessary, pin the folded cloth approximately every 9 cm (3") and remove pins while sewing.
8. Slowly begin to sew while feeling cloth smoothly. **(See Figure 4)**

Purchase direct from vendor online: <https://tumblecat.com/products/easy-hemming-sewing-foot#qv>